



SELF-CENTERING VISE

Models:
SCD430
SCD640



Kurt has two Self-Centering vises, a 4" jaw width (SCD430) and a 6" jaw width (SCD640). Jaw opening on the 4" model is 6.25" and 8" on the 6". Centering accuracy from minimum to maximum opening is 0.0006" with 0.0002" repeatability. Both movable jaws are AngLock design with zero lift. A unique feature is an adjustment that allows the centerline of the jaws to be set. This is especially important when mounting several vises on one machine and all centerlines must match.

Features:

- Lip seals on main screw.
- Chip guards.
- Hardened jaws.
- Hardened bed ways.
- 80,000-PSI ductile iron construction.

JAW POSITION

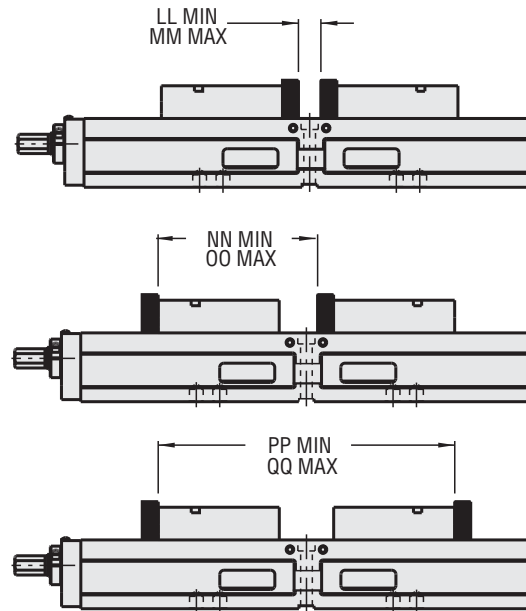

SELF-CENTERING VISE

TOP VIEW

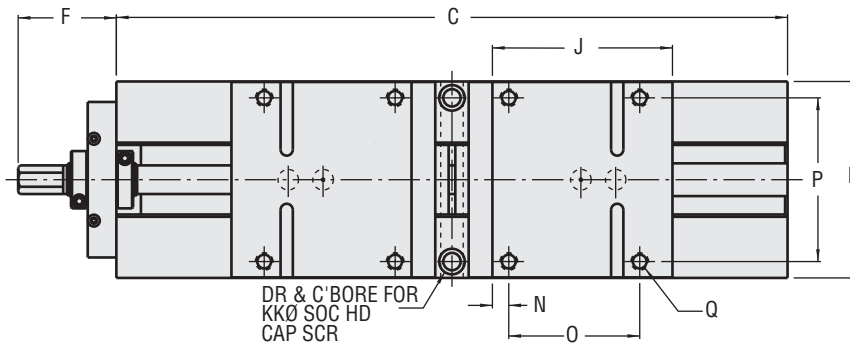

SIDE VIEW

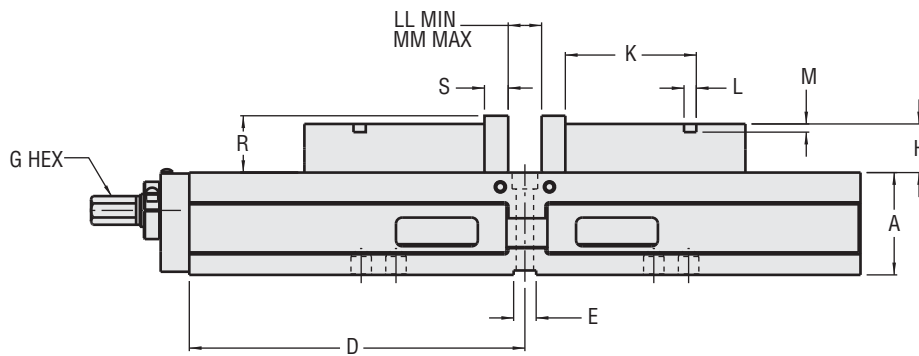

BOTTOM VIEW
(Mounting hole pattern)

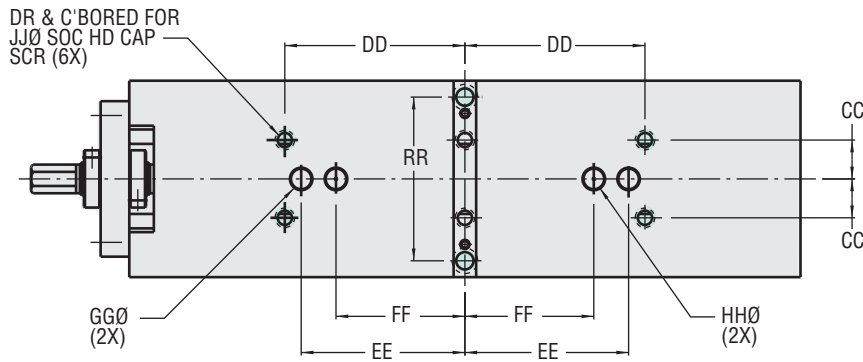

FRONT VIEW

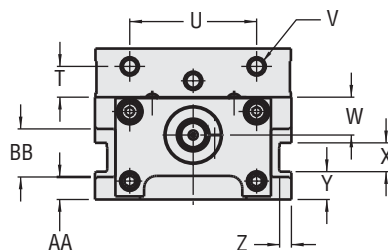

VICE CLAMPING FORCE-LBS.

Torque-Ft. Lbs.	SCD430	SCD640
10	912	985
20	1,757	1,760
30	2,410	2,576
40	2,935	3,770
50	3,549	4,382
60	4,902	5,764

DIMENSIONAL DATA

	SCD430	SCD640
A	2.375	3.125
B	4.000	6.000
C	15.500	20.500
D	7.750	10.250
E	0.5005	0.6880
F	2.400	3.000
G	9/16	3/4
H	1.115	1.485
J	4.000	5.500
K	3.000	4.000
L	0.250	0.375
M	0.188	0.250
N	0.312	0.500
O	3.000	4.000
P	3.312	5.000
Q	5/16-18	1/2-13
R	1.235	1.735
S	0.547	0.725
T	0.687	0.940
U	2.500	3.875
V	3/8-16	1/2-13
W	0.871	1.156
X	0.690	0.880
Y	0.700	0.850
Z	0.250	0.360
AA	0.550	0.690
BB	1.000	1.470
CC	0.813	1.188
DD	3.750	5.500
EE	5.000	5.000
FF	3.370	3.937
GG	0.625	0.625
HH	0.630	0.630
JJ	5/16	3/8
KK	3/8	1/2
LL	1.000	1.000
MM	6.250	8.000
NN	5.540	7.240
OO	10.790	14.240
PP	10.090	13.470
QQ	15.340	20.470
RR	3.000	5.000
Ship Wt. Lbs.	40	100